



InBio Series

IP-Based Biometric Access Control Controller



Fingerprint



RFID



TCP/IP



Wiegand



RS485

Compatible with

ZKBio Access IVS



InBio160



InBio460



InBio260



InBio-460 Package B

InBio series is an IP-based biometric access control controller with versatile and flexible functions and it is highly favored in the medium access control management projects with security requirements.

This controller has dual authentication methods, with fingerprint and RFID card verification technology. Additionally, the **InBio series** can be managed by TCP/IP via a LAN network and is compatible with **ZKBio Access IVS** by pull firmware, offering advanced access control solution features.

A further key component of the inBio series is its compatibility with KR601E, KR602E reader (through Wiegand), KR503E-RS reader (through RS485), and FR1200 fingerprint reader (through RS485), allowing additional verification modes such as fingerprint, IC card and pin code password which provides an extra layer of security and control, ensuring the safety and security of facilities and assets.

Features



Truly Internal Biometric Identification

InBio carries out the matching of fingerprints on the panels. The FR Series readers transmit fingerprint templates to InBio via RS485 for fast and accurate matching with templates stored in the database. Wiegand inputs are also available for traditional RFID readers.



More than Door Control

Access additional control and interface. After programming, auxiliary relays can function as lights, alarms and intrusion detection panels. Also, users can access different locking devices and gate controllers.



Communication

InBio controllers can be installed easily on your network and support HTTP communication.



Three Types of Controller Options

InBio controller has 3 sizes to suit project needs and reduce the cost of unused capacity. 1-door, 2-door, and 4-door models can be mixed and matched in an optimized system architecture.



Optimum Capacity

Support up to 3,000 fingerprint templates, 30,000 badge users and store up to 100,000 events and transactions. Data is preserved if power is lost. Controller continues to operate if network connection is interrupted.



Advanced Access Control Built-In

Anti-Passback, First-Card Opening, Multi-Card Opening, Duress Password Entry, and Auxiliary input/output linkages are built into controller firmware.



Budget Friendly

Save cost. Controller firmwares can be upgraded without any advanced tools. New features can extend and expand the value of your investment.



SDK

The Pull SDK is available for integrators and OEMs to integrate the inBio series biometric access control controller with the existing security or personnel management applications. Upon request, ZKTeco can customize inBio firmware to meet any requirements.

Specifications

	InBio-160	InBio-260	InBio-460
Number of doors controlled	1 Door	2 Door	4 Door
Numbers of readers supported	4 (2*RS-485 Readers, 2* 26/34-bit Wiegand Readers)	8 (4*RS-485 Readers, 4*26/34-bit Wiegand Readers)	12 (8*RS-485 Readers, 4*26/34-bit Wiegand Readers)
Types of readers supported	26/34-bit Wiegand and RS485 FR Series Reader	26/34-bit Wiegand and RS485 FR Series Reader	26/34-bit Wiegand and RS485 FR Series Reader
Number of Inputs	3(Exit Button and Door Status, 1 AUX)	6(2 Exit Button, 2 Door Status, 2 AUX)	12(4 Exit Button, 4 Door Status, 4 AUX)
Number of Outputs	2 (1-Form C Relay for Lock and One Form C Relay for Aux Output)	4 (2-Form C Relay for Lock and 2-Form C Relay for Aux Output)	8 (4-Form C Relay or Lock and 4-Form C Relay for Aux Output)
Card holders Capacity	30,000	30,000	30,000
Fingerprint Capacity	3,000	3,000	3,000
Log Events Capacity	100,000	100,000	100,000
Communication	TCP/IP	TCP/IP	TCP/IP
Dimension(L*W*H)	185x106x36mm	185x106x36mm	226x106x36mm
Net Weight	0.82Kg	0.93Kg	1.11Kg
Power	9.6V-14.4V DC	9.6V-14.4V DC	9.6V-14.4V DC
Operating Temperature	0-45 °C	0-45 °C	0-45 °C
Operating Humidity	20% to 80% RH	20% to 80% RH	20% to 80% RH
Installation Method	Wall mount (metal enclosure box)		
Certification	ISO9001, ISO14001, CE, FCC		
Supported Software	ZKBio Access IVS		

InBio160/260/460 Package B



Item	Description	Quantity
InBio160/260/460	Control Panel	1 ea
Case04	Metal Enclosure	1 ea
TPM003B/PM005B	Power supply (Support charge for backup battery) TPM003B (DC 12V 3A)for InBio160 Package B; TPM005B (DC 12V 5A)for InBio260/460 Package B;	1 ea
FR107	Diode for Lock	1 ea
Key	Key for Metal Enclosure	2 ea
Installation Guide		1 ea
Gross Weight	3.6Kg to 3.7Kg	
Dimension(L*H*W)	350(L)×90(H)×300(W)mm	

Configuration

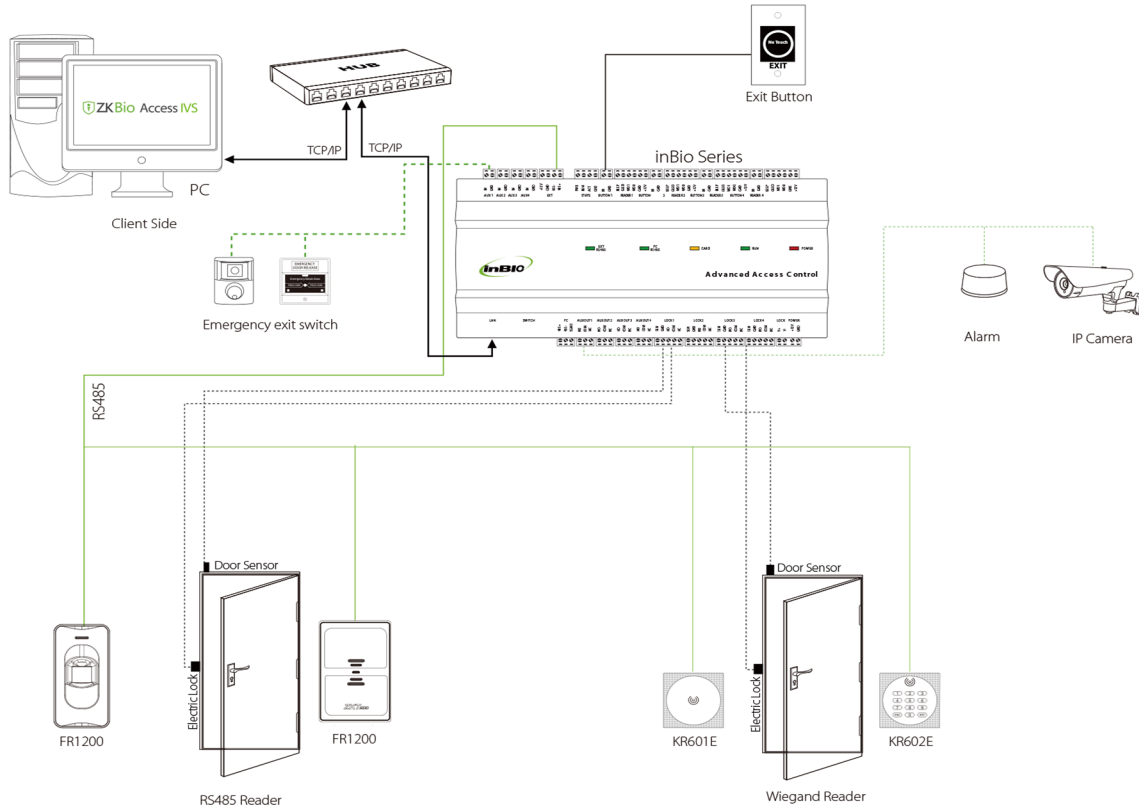

Dimensions(mm)

